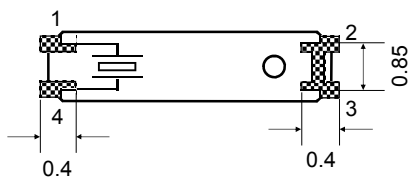
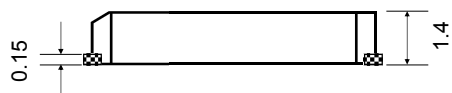
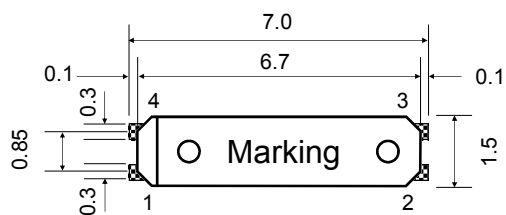

PLASTIC MOLDED SMD TUNING FORK CRYSTAL (7.0 x 1.5 x 1.4mm)
FEATURES:

- MINITURE TUNING FORK CRYSTAL
- LOW PROFILE FOR HIGH DENSITY PCB DESIGN
- INDUSTRIAL OPERATING TEMPERATURE RANGE (-40°C ~ 85°C)

■ SPECIFICATION

FREQUENCY RANGE	32.768kHz
FREQUENCY TOLERANCE @ 25°C	±20ppm, ±50ppm
TEMPERATURE COEFFICIENT	-0.034ppm ±0.006 ppm / °C ²
OPERATING TEMPERATURE RANGE	-40°C ~ 85°C
STORAGE TEMPERATURE RANGE	-55°C ~ 125°C
TURN OVER TEMPERATURE	25°C ± 5°C
LOAD CAPACITANCE	STD: 12.5pF (See P/N guide for other options)
SHUNT CAPACITANCE	1.20pF typ.
MOTIONAL CAPACITANCE	0.0023pF typ.
EQUIVALENT SERIES RESISTANCE	65kΩ max.
INSULATION RESISTANCE	500MΩ min. @ 100V _{DC} ± 15V _{DC}
DRIVE LEVEL	0.1μW typ. 1.0μW max.
AGING @ 25°C ± 3°C	±3.0ppm/ 1 st year max.
SHOCK	±5.0ppm max.
VIBRATION	±5.0ppm max.

■ PACKAGE DIMENSIONS

Unit : mm

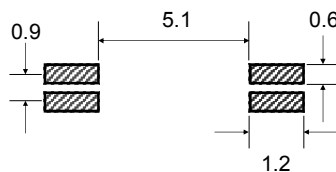
■ SOLDER PATTERN

Unit :mm

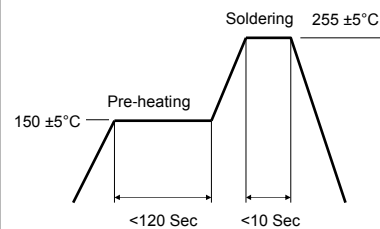
■ REFLOW PROFILE

Note: Consult factory for detail

■ PART NUMBERING GUIDE
